

12601 SERIES

BRASS BALL VALVE SOCKET X MALE THREADED BLACK HANDLE

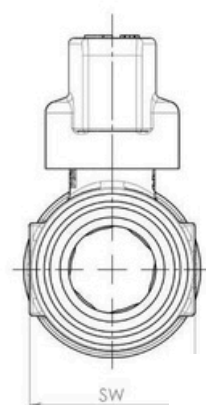
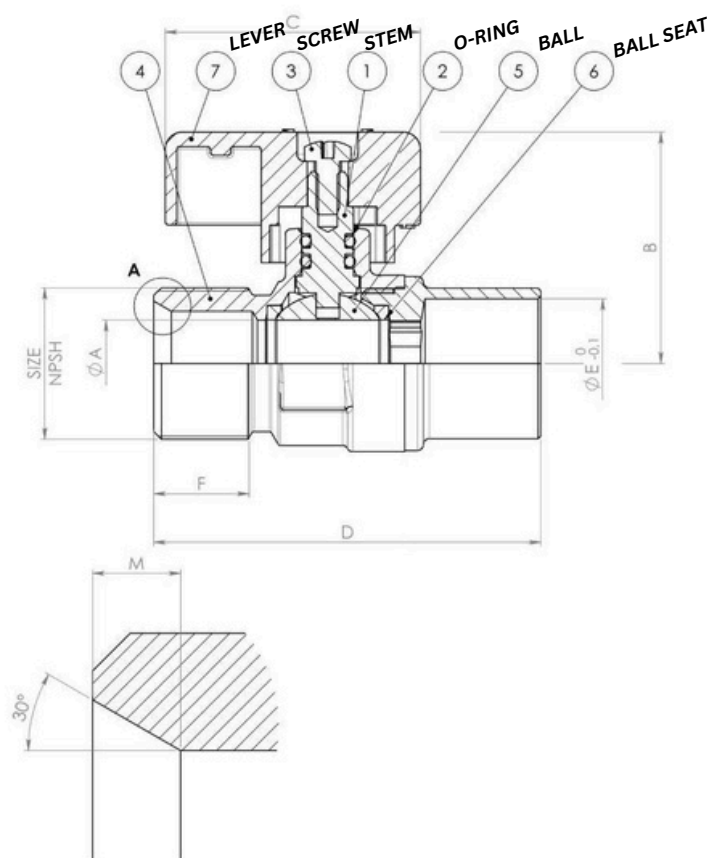

MADE IN ITALY

SPECIFICATION

BRASS BODY

SIZES: 3/4"

BLACK T-HANDLE

CONNECTION: SOCKET X MALE THREADED

PRESSURE:

580 PSI

TEMPERATURE: -4°F TO 266°F

APPLICATION: HOT AND COLD WATER,
COMPRESSED AIR, OILS, NON-AGGRESSIVE FLUIDS

DIRECTION OF FLOW: IN BOTH WAYS

COMPONENTS

N°	DESCRIPTION	MATERIAL
1	STEM	CW614N
2	O-RING	EGM 0.14
3	SCREW	ZINC PLATED STEEL
4		CW617N
5	BALL	CW614N
6	BALL SEAT	PTFE
7	LEVER	ALUMINUM

DIMENSIONS

INCHES

CODE	SIZE	DN	ØA	B	C	D	E	M	F	SW	PN	CV
12601-007	3/4" x 3/4"	0.787	0.591	1.575	1.732	2.628	0.881	0.118	0.61	1.122	40	17.4